

LEASE-ALL ORANGETHORPE

102,390 Square Feet of Industrial/Office Suites



920-980 E. Orangethorpe Avenue
Anaheim, California

Property Features:

- Units from 1,470 to 5,000 sq. ft.
- 10% to 100% air conditioned office build out
- 13' to 14' minimum warehouse clearance
- Ground level truck loading
- 100 amps, 120/280v 3-phase panels (some units)
- 2:1 parking ratio
- Some units with street frontage
- Excellent access to Riverside (91), Orange (57), and Santa Ana (5) Freeways

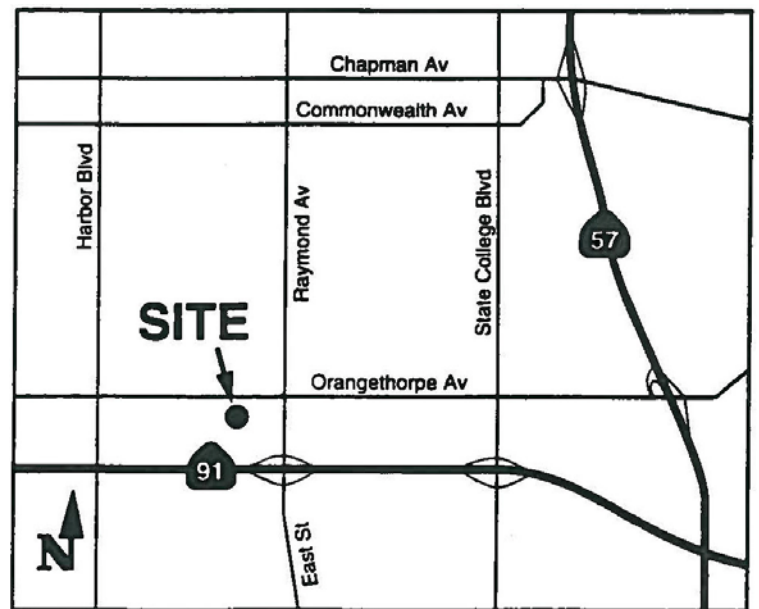

Thomas Guide: (OC) 769-A1

The information above has been obtained from sources believed reliable. While we do not doubt its accuracy, we have not verified it and make no guarantee, warranty or representation about it. It is your responsibility to confirm its accuracy and completeness. Any projections, opinions, assumptions or estimates used are for example only and do not represent the current or future performance of the property. The value of this transaction to you depends on tax, and other factors which should be evaluated by your tax, financial and legal advisors. You and your advisers should conduct a careful, independent investigation of the property to determine to your satisfaction the suitability of the property for your needs.

For Leasing Information Please Contact:

ESSEX | Management
Investment
Development

(714) 237-7032

4055 La Palma Ave., Suite H-1, Anaheim, CA 92807

Lease All - Orangethorpe Industrial Park 920 - 980 E. Orangethorpe Avenue, Anaheim, California

Orangethorpe Avenue

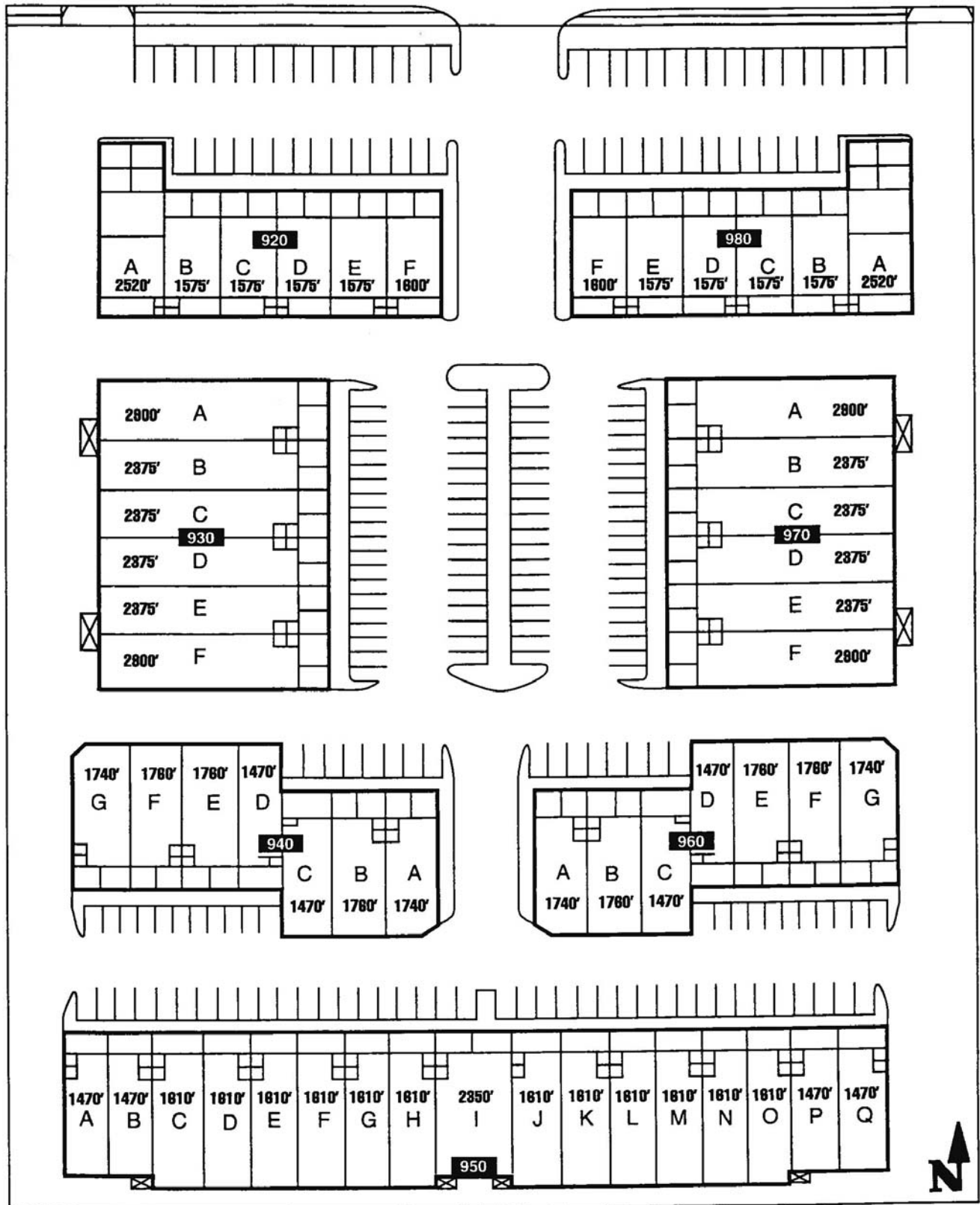

The information above has been obtained from sources believed reliable. While we do not doubt its accuracy, we have not verified it and make no guarantee, warranty or representation about it. It is your responsibility to confirm its accuracy and completeness. Any projections, opinions, assumptions or estimates used are for example only and do not represent the current or future performance of the property. The value of this transaction to you depends on tax, and other factors which should be evaluated by your tax, financial and legal advisors. You and your advisers should conduct a careful, independent investigation of the property to determine to your satisfaction the suitability of the property for your needs.